

SURGICALLY CLEAN AIR

ELECTRONIC AIR PURIFIER

OPERATIONAL MANUAL

Model No. SCA6000C



WARNING:

- *Before operating the system, please read this manual thoroughly, and retain it for future reference.*
- *This unit cannot be used in an atmosphere containing explosive dust, gas or oxygen, or in an area where flammable dust is present.*
- *This product can be used only where the power supply is 120V/60Hz. You cannot use the unit if the power voltage is different.*

SURGICALLY CLEAN AIR

3451 Lake Shore Blvd. W.
Toronto, ON M8W 1N2
Tel: 1-877-440-7770
www.surgicallycleanair.com
info@surgicallycleanair.com

CONTENTS

	FOR CUSTOMER ASSISTANCE	E-4
	CONSUMER LIMITED WARRANTY	E-5
Chapter 1	IMPORTANT SAFETY PRECAUTIONS	E-6~10
Chapter 2	HOW IT WORKS	E-11
Chapter 3	PART NUMBER AND NAME	E-12
Chapter 4	FEATURES AND SPECIFICATIONS	E-13
	Features	E-13
	Specifications	E-13
Chapter 5	OPERATION	E-14~15
	Button Operation	E-14
	Display Indicator Lights	E-15
	Remote Control Operation	E-16
Chapter 6	CARE AND MAINTENANCE	E-17~19
	Cleaning the Pre-filter	E-17
	Cleaning the Electronic Cell	E-17
	Replacing the Filter	E-18
	Replacing UV Lamp	E-19
	Photo catalytic Filter	E-19
Chapter 7	FREQUENTLY ASKED QUESTIONS	E-20
	Why does my air purifier spark?	E-20
	How should I clean the cell?	E-20
	How often should I change the Filter?	E-20
Chapter 8	TROUBLESHOOTING	E-21
Chapter 9	WIRING DIAGRAM	E-22
	SERVICE REMINDER SCHEDULE	E-23

FOR CUSTOMER ASSISTANCE

SURGICALLY
CLEAN AIR
3451 Lake Shore Blvd. West
Toronto, ON M8W 1N2

Tel: 1-877-440-7770

If you have questions about your air purifier, call the customer service number. Before calling, please note the model and serial number located on the back of the unit and fill in the following information below. This information will help us answer your questions much more quickly.

Model number

Serial number

Date of purchase

Dealer name

Address

City

Province

Postal code

Telephone

Phone: 1-877-440-7770

Write: For service problems, guarantee information, missing items and other assistance:

SURGICALLY CLEAN AIR
3451 Lake Shore Blvd. West
Toronto, ON M8W 1N2

Please provide the following information when you write or call: model number, serial number, date of purchase, your complete mailing address (including Postal Code), your daytime telephone number (including area code) and description of the problem.

CONSUMER LIMITED WARRANTY

LIMITED WARRANTY

Congratulations on your investment

Surgically Clean Air (Hereinafter called SCA) gives you the following limited warranty for this product only if it was originally purchased from SCA or from an authorized dealer.

SCA warrants that this product is free, under normal use and maintenance, from any defects in material and workmanship. If any such defects should be found in this product within the applicable warranty period. SCA shall, at its option, repair or replace the product as specified herein.

SCA will repair or replace, free of charge, to the original purchaser, any part that is found to be defective in material or workmanship within one (1) year of the date of purchase. This limited warranty does not cover the replacement of expendable or consumable parts such as filters, and other parts subject to normal wear unless they are defective in material or workmanship.

This warranty shall not apply if:

(A) Any defects caused or repairs required because of abusive operation, negligence, accident, improper installation or inappropriate use as outlined in the operation manual.

(B) Any product tampered with modified, adjusted or repaired by any party other than SCA, SCA Authorized Service Centers or Dealers.

(C) Damaged caused or repairs because of the use with items not specified or approved by SCA.

(D) Any damage caused by external or environmental conditions, including but not limited to the use of voltage other than indicated on the product.

SCA's limited warranty is valid only if you retain proof of purchase from SCA or a SCA Authorized Retail Dealer for this product.

To obtain the name and address of the nearest Authorized Surgically Clean Air Dealers, please contact:

3451 Lake Shore Blvd. West
Toronto, ON M8W 1N2

For more information on this Warranty, Dealers or Service Locations, please call 1-877-440-7770
Visit our website: www.surgicallycleanair.com

Chapter 1

IMPORTANT SAFETY PRECAUTIONS

Power Cord

Unit Operation

TO REDUCE THE RISK OF ELECTRICAL SHOCK, FIRE OR INJURY TO PERSON(S) READ THE FOLLOWING:

- Use only as described in this manual.
 - Use only a 120-volt outlet with grounding wire receptacle.
 - Do not use the air purifier if the power cord or plug is damaged or the connection to the wall outlet is loose.
 - When removing the power plug, always hold the plug and never pull by the cord.
 - Do not handle plug or appliance with wet hands. **Electrical shock or fire from short circuit may occur.**
 - Remove the power plug from the wall outlet before cleaning the unit and when not using the unit. Turn off all controls before unplugging.
 - If the power cord is damaged, it must be replaced by the SCA authorized service or similarly qualified person.
 - To reduce the risk of electric shock, this equipment has a grounding type plug that has a third (grounding) pin. This plug will only fit into a grounding type power outlet. If the plug does not fit into the outlet, contact qualified personnel to install the proper outlet. Do not alter the plug in any way.
-
- **Do not use the unit in an enclosed space where oxygen, flammable, explosive or toxic vapors are given off by oil base paint, paint thinner, some mothproofing substances, or in an area where flammable dust is present.**
 - Do not clean outside with paint thinner or any chemicals. If so, the unit surface may become damaged or may cause fire.
 - Do not wash or reuse the activated carbon filter.
 - Do not operate the unit without filters.
-
- Do not insert fingers or foreign objects into the intake or air outlet.
 - Keep hair, loose clothing, fingers and all parts of body away from openings and moving parts.
 - Do not block the intake and air outlet.
 - Do not use the unit near or on hot objects, such as range or where it may be exposed to steam.
 - Always hold the handles on the side of the unit when moving it. Holding the front panel when carrying may cause it to detach, and result in bodily harm.
 - Be careful not to tip over the unit when opening the front panel. If not, it may cause bodily harm.
-
- The batteries must be removed from the remote control before disposal, and the batteries must be disposed of safely.
-
- This product complies with the maximum allowable concentration of ozone of 0.050 parts per million by volume (ppmv) in a 24-hour period. The Health Canada Guideline 2010 (ISBN 978-1-100-16288-1) recommends that the maximum exposure limit, based on an average time of 8 hours, is 0.020 ppmv or less when tested in a sealed, controlled room approximately 30m³.

Chapter 1

IMPORTANT SAFETY PRECAUTIONS



WARNING

If you do not follow these instructions exactly, the unit may cause property damage, personal injury or loss of life.

WARNING:

- Do not use the unit in the places containing explosive dust, gas or flammable substances.
- Do not clean the unit or any parts with flammable substances.
- Do not wash or reuse the activated carbon filter.

This manual classifies precautions into WARNINGS and CAUTIONS. Be sure to follow all precautions below: They are important for ensuring your safety.

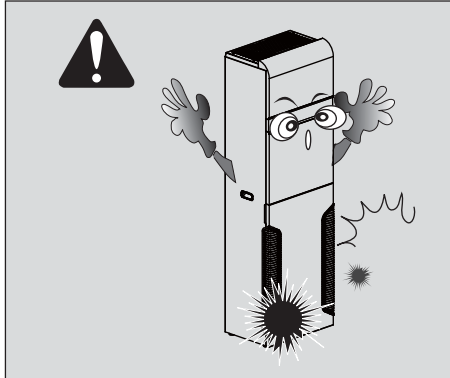

1. This unit cannot be used in an atmosphere containing explosive dust, gas or in an area where flammable substances are present. If so, it results in explosion or fire!

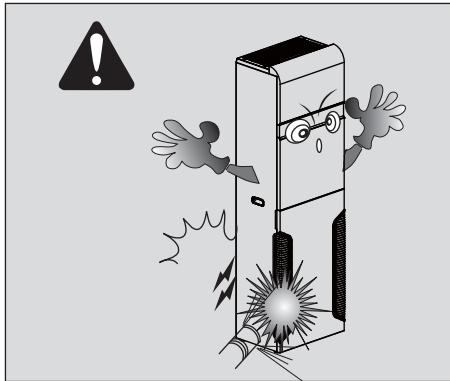

2. Do not clean the unit or any parts (e.g. pre-filter, electronic cell or activated carbon filter etc.) with alcohol, gasoline, paint thinner or other flammable substances. **It may cause fire!**

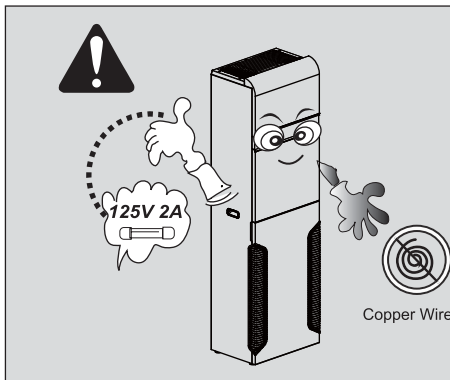

3. Use a fuse with proper capacity. Never use a wire in place of a fuse. Doing this may lead to malfunction or fire.

Chapter 1

IMPORTANT SAFETY PRECAUTIONS



WARNING

If you do not follow these instructions exactly, the unit may cause property damage, personal injury or loss of life.

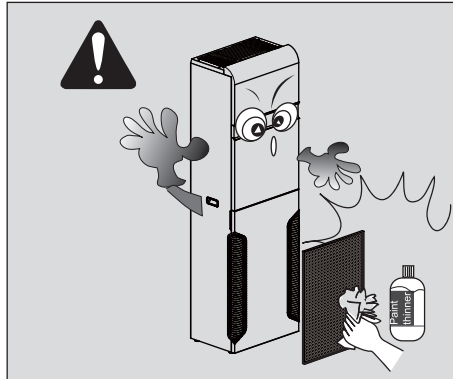

4. DO NOT wash or reuse the activated carbon filter and the chemical filter or clean the filters with liquid, especially alcohol, gasoline, paint thinner, etc.. **It may cause fire!**

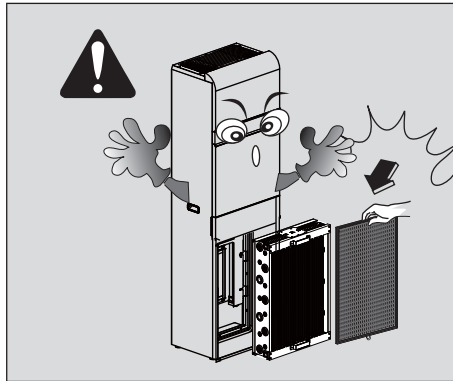

5. The activated carbon filter and the chemical filter must be located behind the cell. DO NOT place the filters in front of the cell. **It may cause fire!**

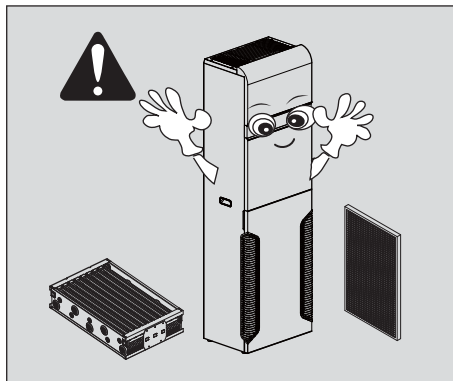

6. After cleaning the Pre-filter, it is very important to dry it completely before placing it back in the unit. DO NOT clean Pre-filter with flammable substances (Alcohol, gasoline, paint thinner, etc.). **It may cause fire!**

Chapter 1

IMPORTANT SAFETY PRECAUTIONS



WARNING

If you do not follow these instructions exactly, the unit may cause property damage, personal injury or loss of life.

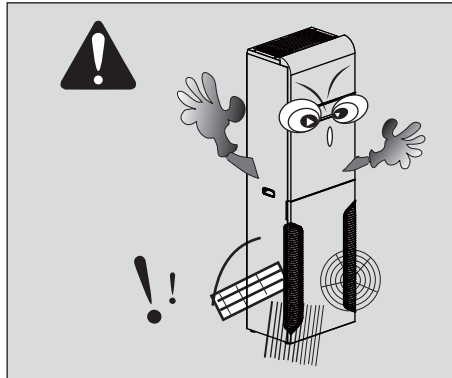

7. Do not disassemble or modify this equipment. Unwarranted tampering can lead to fire, electric shock and unit malfunction.

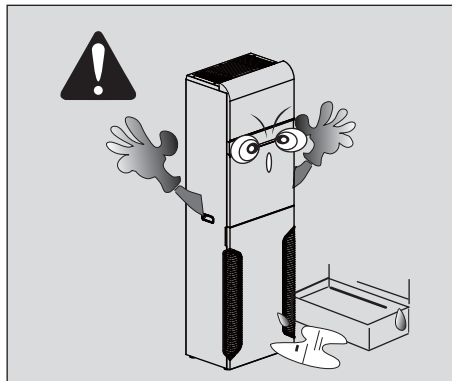

8. Do not use the unit in humid places that might be wet. Contact with water can lead to electric shock or damage the equipment.

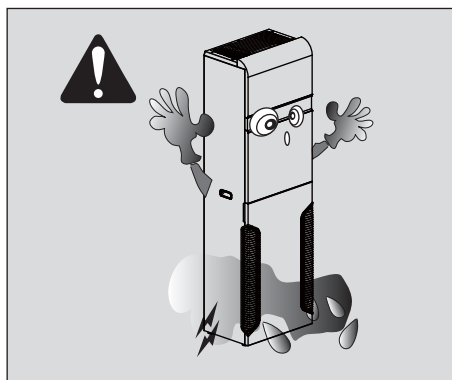

9. If any parts of the power source gets wet remove the plug and dry it completely before reusing.

Chapter 1

IMPORTANT SAFETY PRECAUTIONS



WARNING

If you do not follow these instructions exactly, the unit may cause property damage, personal injury or loss of life.

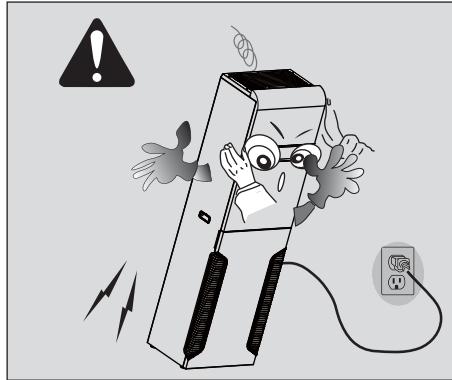

10. Be careful not to tip over the unit when opening the front panel or moving it. **If not, It may cause personal injury.**

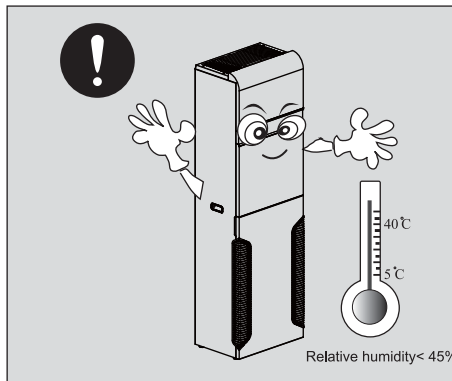

11. Do not use the unit in high humidity conditions. Use the product in the ambient relative humidity of 45%.

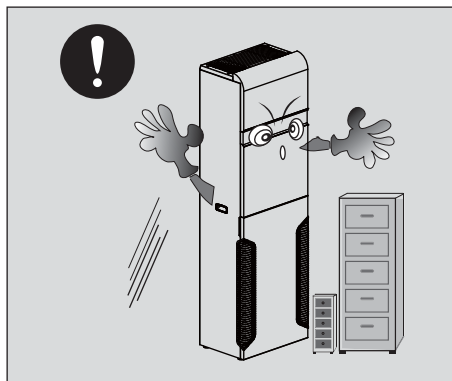

12. Do not block the intake or outlet. Blocked openings can reduce capacity or damage the unit.

Chapter 2

HOW IT WORKS

The air is cleansed in seven stages

Part Name

- Stage 1
Pre-filter
- Stage 2
Electronic Cell
- Stage 3
Activated Carbon Filter
- Stage 4
Chemical Filter
- Stage 5
UV-C Germicidal Lamp
- Stage 6
Photo catalyst
- Stage 7
Negative Ion Generator

The air purifier functions as an air cleaner by helping to disinfect airborne microorganisms and removing particulates from the air.

The centrifugal fans of the unit draw air through the front panel (Intake) on the front of the unit. Then it passes through the Pre-filter, the electronic cell, the activated carbon filter, chemical filter and the UV-Photo catalytic sterilization chamber. The purified air is then released through the outlet on the top of the unit.

The air is cleansed in seven stages:

1. The Pre-filter traps large dust particles.
2. The two-stage electrostatic precipitator (Electronic cell) captures airborne particles, as small as 0.01 microns. In the ionizing section of the electronic cell, billions of microscopic particles become electrically charged as they pass through the powerful electric field. The collector plates immediately attract and collect these charged dust and dirt particles.
3. The activated carbon filter absorbs and reduces odors.
4. The chemical filter absorbs the certain chemical gases and removes odors.
5. The UV sterilization chamber kills bacteria and viral microorganisms such as influenza, TB and Legionnaire's Disease as well as other harmful contaminants.
6. When UV light hits the photo catalytic filter, it creates e- and h+, which have an excellent effect in the decomposition of odors.
7. The unit also generates negative ions that freshens the room air.

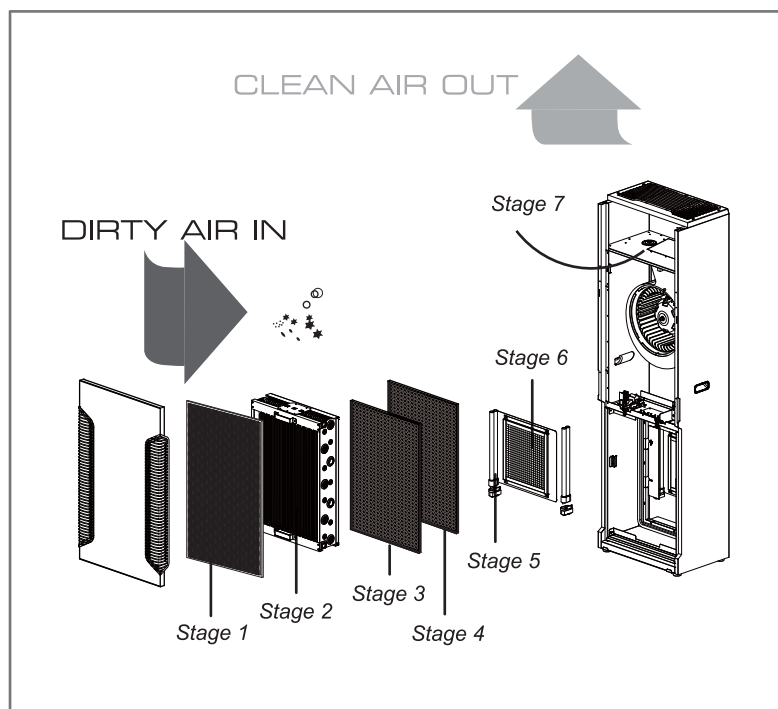

Chapter 3

PART NUMBERS AND NAMES

PART NUMBERS

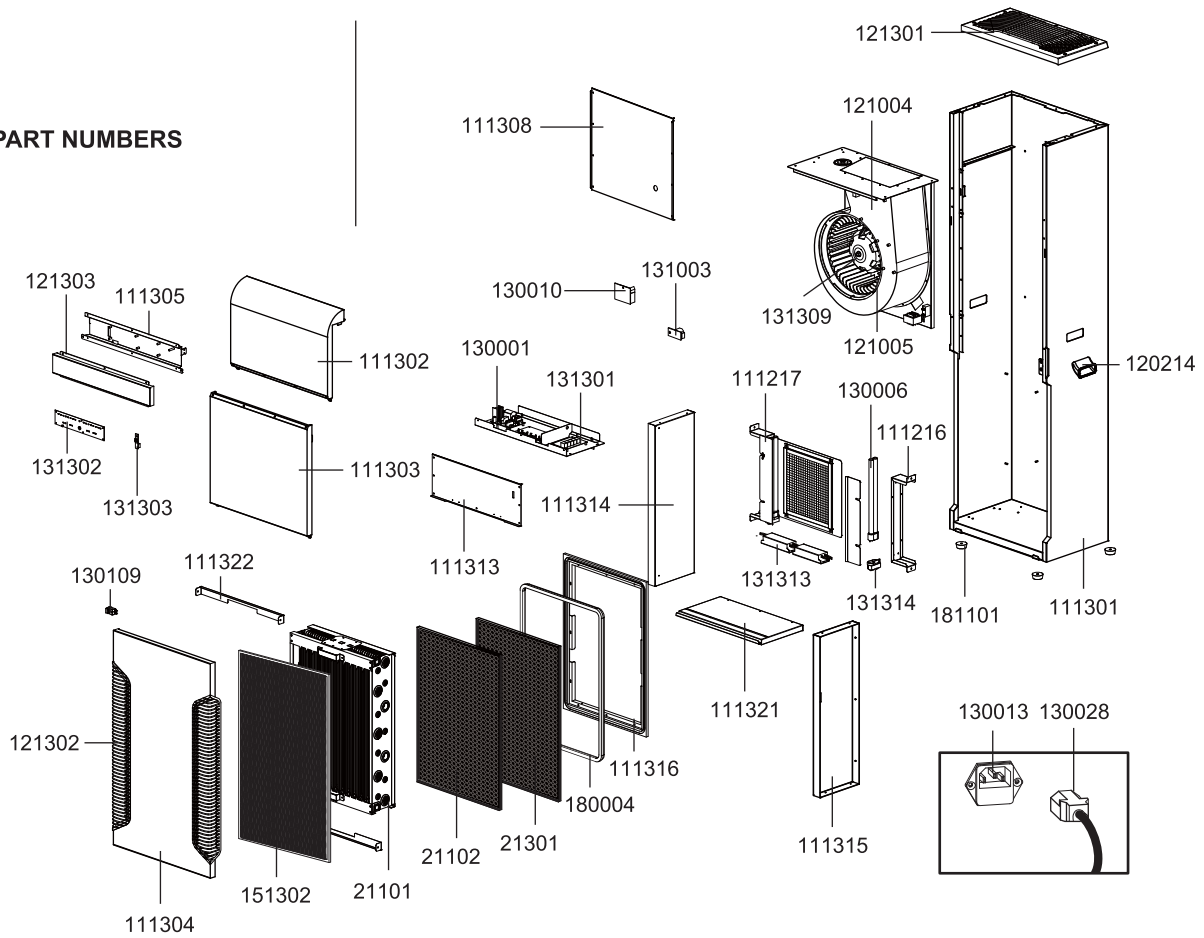

PART NAMES

- | | |
|---------------------------------|-------------------------------|
| 111304 Front panel | 111308 Fan motor front plate |
| 121302 Front air inlet | 130010 Particle sensor |
| 130109 Interlock switch | 131003 Odor sensor |
| 111322 Cell protector | 111321 Metal bottom plate |
| 151302 Pre-filter | 111314 Metal side plate-Left |
| 21101 Electronic cell | 111315 Metal side plate-Right |
| 21102 Activated carbon filter | 131313 UV lamp ballast |
| 21301 Chemical filter | 131314 UV lamp holder |
| 180004 Rubber gasket | 130006 UV lamp |
| 111316 Rubber gasket holder | 111216 UV lamp bracket |
| 131302 Display circuit board | 111217 UV light blocker |
| 131303 Remote receiver board | 131309 Fan motor |
| 121303 Display panel | 121004 Fan housing |
| 111305 Display panel back cover | 121005 Fan blade |
| 111302 Upper panel | 121301 Plastic air outlet |
| 111303 Middle panel | 120214 Unit handle |
| 111313 Repair cover | 111301 Unit housing |
| 131301 Main circuit board | 181101 Rubber feet |
| 130001 Power supply | 130013 Power cord socket |
| | 130028 Power cord |

Chapter 4

FEATURES AND SPECIFICATIONS

Features

Product Specifications

FEATURES



Multi-Stage Filters

The unit utilizes a two-stage electrostatic precipitator (Electronic cell) combined with a Pre-filter (For large particles), an Activated carbon filter, a Chemical filter (For odors and gases), UV germicidal light (Killing airborne pathogen), a Photo catalytic filter (Removes VOC's) and a Negative ion generator.

Automatic Function

The odor and particle sensor can let the unit automatically select the appropriate fan speed depending on the air quality detected.

Filters , UV Lamps Replacement Indicator Lights

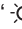
The “” “” and “” indicator lights tell you when to replace the activated carbon filter, chemical filter or the UV lamps.

Safety Micro-Switch (Interlock switch)

This air purifier is equipped with a safety interlock switch (Micro-safety switch) that will turn the unit off if the front panel is removed while the unit is running.

Easy Maintenance and Low Cost

When the electronic cell needs to be washed or the filters need to be replaced, simply open the front panel and pull out the electronic cell or old filters and put the new or clean one in.

No screws, hooks or tools are required. The electronic cell captures small particles on aluminum plates that are simply rinsed off in the sink. There are no expensive filters to replace.

SPECIFICATIONS

Model No.	SCA6000C
Power Requirement	a.c120V, 60Hz
Rated Power	Max.182W
Noise Level	≤55dB(A)
Negative Ion	>3×10 ⁶ /cm ³
UV Lamp	24Wx2
Main unit	Pre-filter, Electronic Cell, Activated Carbon Filter, Chemical Filter, UV light-Photo catalyst system, Negative Ion Generator
Fan Motor	120V, 60Hz
Fan Speed	L-410m ³ /h M-550m ³ /h H-690m ³ /h
Dimensions	168.5cmx50cmx34.5cm
Weight	56.1kg

STANDBY POWER

In order to operate the electrical circuits while the power plug is inserted in the wall outlet, this product consumes about 6W of standby power. For energy conservation, unplug the power cord when the unit is not in use.

Chapter 5

OPERATION

BUTTON OPERATION

Helpful Hints

RESET Button

- After cleaning the electronic cell, hold the SPEED button down 3 seconds to reset the cell cleaning time with beeping sound.
- After the replacement of activated carbon filter or chemical filter, make sure to hold the TIMER button 3 seconds to reset the timer.
- After the replacement of UV lamps, make sure to hold the UV LAMP button 3 seconds to reset the timer.

Note: Before pressing the RESET button, be sure the unit is plugged in.

New Functions

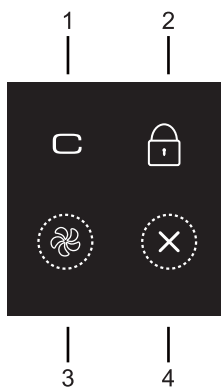

BUTTONS

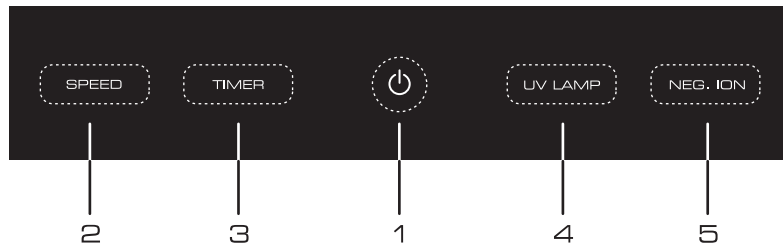

1. POWER Button

Turns the purifier On and Off.

2. SPEED Button

When the SPEED button is pressed the airflow rate changes as shown below: L (speed 1) -- M (speed 2) -- H (speed 3) -- a (auto mode).

3. TIMER Button

Press the TIMER button to select the time for operation. The timer setting switches as shown: 1hr -- 2hr -- 4hr -- C (timer cycle function) -- cancel timing.

4. UV LAMP Button

When the button is pressed, it will turn on the UV lamps, pressing again will turn off the UV light.

5. NEG.ION Button

When pressed, the generation of ions will cease and the negative ion generator light will go out.

1. Timer Cycle Function

- Press the TIMER button until this indicator is lighting up. In this case, the unit will start to work for 2 hours and stops 0.5 hours automatically.

2. Lock Function

- Hold the Power button for 3 seconds, the indicator light will light up with beeping. In this mode, the panel is locked.
- If you want to return to the default mode, do the reverse.

3. Cell clean Dry Function

- After cleaning the electronic cell and reset the unit, the indicator light will light up. In this mode, the unit electronic cell does not charge for 1.5 hours allowing time to dry the cell. After running 2 hours, the cell will automatically charge and start to work.

4. Non-power supply Function

- In standby mode, hold the NEG.ION button 3 seconds until the indicator lights up, at the same time you hear the beeping. In this mode, the power supply to the cell is disconnected.
- If you want to return to the default mode, do the reverse.

Chapter 5

OPERATION

DISPLAY INDICATOR LIGHTS

Connect the Power

Plug the unit into an electric outlet, the unit will be ready to run and all the indicators on the display panel will light up for 2 seconds.

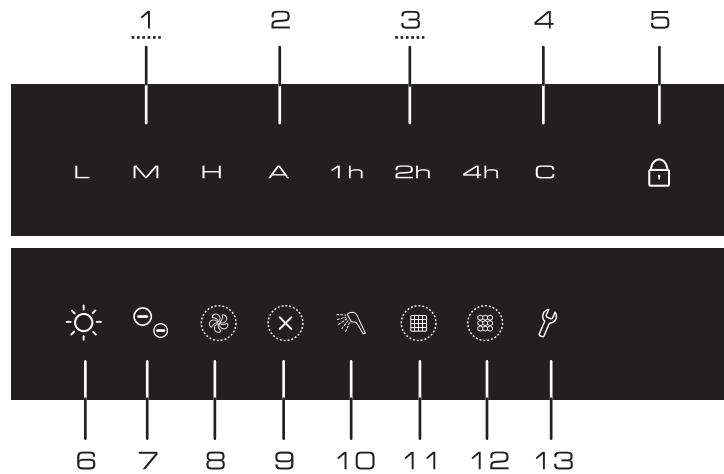

1 SPEED indicator light

When the power is on, the “L” light will light up, select the speed by pressing the SPEED button.

2 AUTO MODE indicator light

When the indicator is lighting up, the unit is at Auto mode.

3 TIMER indicator light

When the TIMER button pressed, the indicator light will light up.

4 TIMER CYCLE indicator light

When this indicator is lighting up, the unit will start to work for 2 hours and stops 0.5 hours automatically, this schedule will repeat itself continuously while in this mode.

5 LOCK FUNCTION indicator light

In this mode, all the buttons will not work.

6 UV LAMP indicator light

The indicator light will light up when the UV light are on. When the indicator light flashes, it is time for the UV bulbs to be replaced.

7 NEG.ION indicator light

When pressed, the generation of ions will cease and the indicator light will light up.

8 CELL CLEAN DRY FUNCTION indicator light

When this indicator is lighting up, the electronic cell does not charge for 1.5 hours allowing time to dry the cell.

9 NON-POWER SUPPLY FUNCTION indicator light

When the indicator is lighting up, the power supply does not work.

10 CLEAN ELECTRONIC CELL indicator light

When this indicator light flashes, the Electronic cell needs to be washed.

11 CHEMICAL FILTER LIFE indicator light

When the indicator light flashes, the Chemical filter needs to be replaced.

12 ACTIVATED CARBON FILTER LIFE indicator light

When the indicator light flashes, the activated carbon filter needs to be replaced.

13 CHECK indicator light

When the machine needs attention, the indicator light flashes red.

Chapter 5

OPERATION

REMOTE CONTROL OPERATION

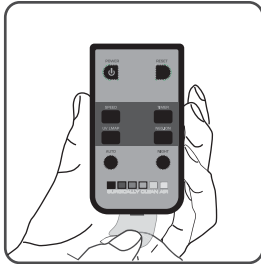

Pull out the clear sheet from the battery cover before using.

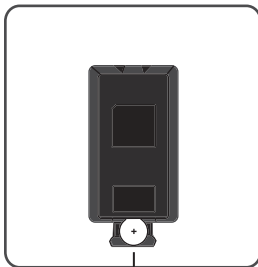

CR2025 Battery

The battery is already set in the remote control, pull out the clear sheet from the battery cover before using.

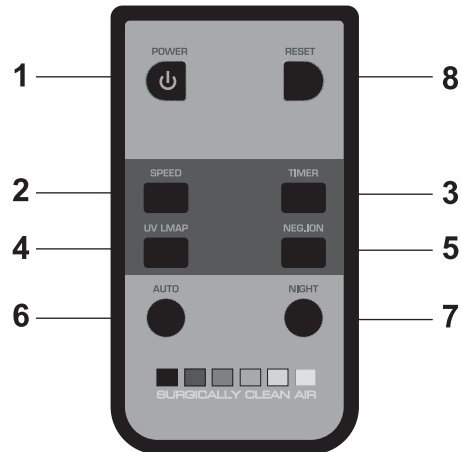

1 Power (ON/OFF) Button

The unit will start operating when the POWER button is pressed. Pressing the button again will stop operation.

2 SPEED Button

The fan speed can be switched among Low, Medium and High settings.

3 TIMER Button

The set time switches every time the button is pressed as shown below: 1hr-2hr-4hr-Cycle-Cancel.

4 UV LAMP Button

Turns UV lights on and off.

5 NEG.ION Button

Turns Negative Ions on and off.

6 AUTO Button

At Auto mode, the fan speed is automatically switched depending on the amount of pollution in the air.

7 NIGHT Button

When pressed, all the indicator lights on the display panel will go out except the Power light on the display panel.

8 RESET Button

Pressing the reset button 8 times will reset all the replacement indicator lights.

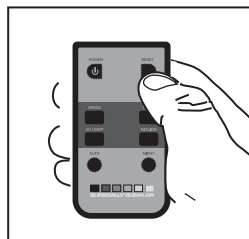

Chapter 6

CARE AND MAINTENANCE



WARNING

Cleaning the unit while it is plugged in may result electric shock, electric spark and serious injury. Unplug the unit before cleaning or maintenance!



WARNING

- DO NOT clean the Pre-filter with flammable substances
- After cleaning the filters, make sure to dry them thoroughly before reinstalling.

To maintain optimum performance of this air purifier, please clean the unit including the Pre-filter and electronic cell periodically. When cleaning the unit, be sure to unplug the power cord, and never handle the plug with wet hands. If so, electrical shock and bodily injury may occur as a result.

Main Unit

Wipe with a dry, soft cloth for stubborn stains or dirt. Do not use **volatile fluids, Benzene, paint thinner, polishing powder**, this may damage the surface. Do not use detergents, detergent ingredients may damage the unit. Keep the unit away from water.

CLEANING THE PRE-FILTER

To assure optimum performance the Pre-filter should be cleaned regularly.



6-1 Open the front panel

- Stop the operation and unplug the unit.
- Hold the front panel upper portion (Left and right side) and pull it toward you.



6-2 Removing the Pre-filter

- Remove the Pre-filter's holder.
- Pull the Pre-filter straight up and out of the front Panel.

Cleaning the Pre-filter

- Using a vacuum cleaner to remove any dust, clean with water.
- If it is very dirty, use a soft brush or a neutral cleaner to clean then dry completely before placing it back into the unit.
- After cleaning the filters, make sure to dry them thoroughly before reinstalling.

Chapter 6

CARE AND MAINTENANCE

WARNING:

- DO NOT clean the cell with alcohol, gasoline, paint thinner or other flammable substances. It may cause fire!
- Before Remove the electronic cell, Stop the operation and unplug the unit.
- Be careful not to snag or cut the ionizing wire. If the unit is operated with the ionizing wire cut, there will be no dust collection.
- DO NOT reinstall the cell until it is completely dry. If the “” indicator light on the control panel flashes red, then the cell may still be wet.
- Be sure there is no detergent residue around the cell ceramic insulators, especially around the square shape ceramic insulators.
- Slide in the cell so the airflow arrow points toward the machine.

CLEANING THE ELECTRONIC CELL

To assure optimum performance the cell should be cleaned every one to two months.

Remove the Electronic Cell

Stop the operation and unplug the unit.

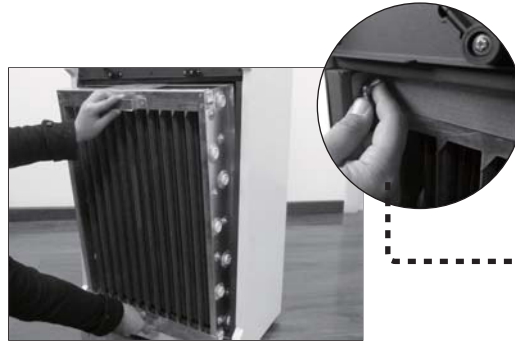

6-3 Hold the electronic cell's handle, pull it toward to you.

Remove the swing screw and take off the cell blocker.

Cleaning the Electronic Cell

Use a large enough container, such as a laundry tub or trash container. Dissolve detergent in warm water to cover the cell. After the detergent has completely dissolved, place the cell in the container. Allow the cell to soak for 15~30 minutes and rinse with clean water.

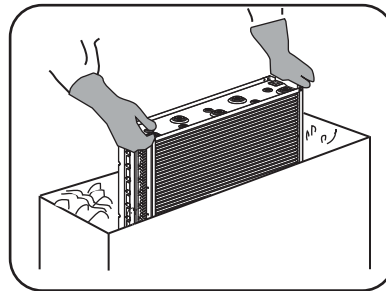

6-4 Cleaning the Electronic Cell

Helpful Hints

If the air quality is extremely poor and the cell is dirty, you may clean the cell before the “” indicator light flashes.

CAUTION:

- Be sure there is no detergent residue around the cell ceramic insulators, especially around the square shape ceramic insulators.
- Dry the cell thoroughly with heat gun before reinstalling.
- Slide in the cell so the airflow arrow points toward the machine.

Chapter 6

CARE AND MAINTENANCE

Note:

Remove plastic packaging from the activated carbon filter before operation.



WARNING

- DO NOT reuse or clean the activated carbon filter and the chemical filter with liquid, especially alcohol, gasoline, paint thinner, etc. It may cause fire!
- DO NOT try to place the activated carbon filter in front of the cell! It may cause fire!

Hold the POWER button 3 seconds to reset

After replacing the activated carbon filter or the UV lamps, hold the POWER button 3 seconds to reset the time for the activated carbon filter or the UV lamps.

REPLACING THE FILTER

When the “☼” and the “☼” indicator lights on the control panel flash, the activated carbon filter and the chemical filter needs to be replaced.

Replacing the Activated Carbon Filter and the Chemical Filter

Stop the operation and unplug the unit.



6-5 Hold the activated carbon filter's handle, pull it toward to you.



6-6 Hold the chemical filter's handle, pull it toward to you.

REPLAYING UV LAMP

When the “☼” indicator light on the control panel flashes, it is time to replace the UV lamps.

Removing the UV lamp

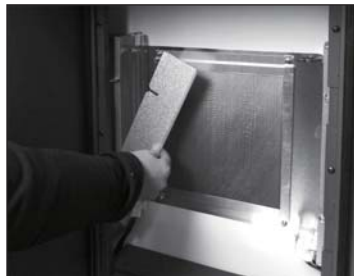

6-7 Remove the UV LAMP blocker.



6-8 Hold the UV LAMP, pull it up remove it from UV LAMP holder.

WARNING:

- Never look directly at UV lamps.
Direct exposure to germicidal light can cause temporary or chronic damage to your eyesight, or even blindness.
- Always unplug the unit before cleaning, servicing or replacing the UV lamps.
- Do not dispose of the UV bulb with normal household waste, hand it in at an official collection point for recycling.

PHOTO CATALYTIC FILTER

Photo catalytic filter is permanent, never needs replacing. When there is dust on it, clean the dust off using a vacuum cleaner dusting brush. Do not wash it in water

CHAPTER 7

FREQUENTLY ASKED QUESTIONS

Why does my air purifier spark?

It is common for the purifier to occasionally spark, crackle or pop during operation.

A spark indicates that the air purifier captured a large air particle. If the unit sparks continuously:

- The electronic cell may be excessively dirty or have a foreign object lodged between the plates. Remove the cell from the unit and wash thoroughly.
- Visually inspect the cell for any foreign debris lodged between the plates. Also, inspect for broken ionizing wires, chipped or cracked ceramic insulators, or bent plates.
- When replacing cell in the unit, make sure the directional arrow on the cell points toward the unit.

How should I clean the cell?

- Stop the operation and unplug the unit.
- Please wait 5-10 seconds before opening the front panel.
- To assure optimum performance the cell should be cleaned every month.
- Use a large enough container, such as a laundry tub or trash container. Dissolve detergent in warm water to cover the cell. After the detergent has completely dissolved, place the cell in the container. Allow the cell to soak for 15~30 minutes and rinse with clean water. Tough residue may need longer soaking.
- After cleaning, make sure to rinse detergent residue thoroughly out of the ceramic insulators of the cell. Dry the cell thoroughly before reinstalling.

Important Note:

It is very important that the cell is allowed to dry completely before sliding them back into the cell cabinet as electricity is passed through the cell.

How often should I change the filter ?

The function of the activated carbon filter/chemical filter is to adsorb odors and freshen the air. When the replacement indicator light on the control panel flashes, you should replace the activated carbon filter and the chemical filter.

Chapter 8

TROUBLE SHOOTING

The system does not operate at all

Service problems that appear to be major can often be solved easily. You can be your own troubleshooter by reviewing the following guide. All other servicing should be done by a SCA authorized service center.

Power failure?	Check other electrical appliances.
Power plug disconnected?	Make sure to insert the plug.
Is the fuse burnt?	Replace the FUSE with new one.
Front panel open or interlock switch failure?	The unit does not operate when the front panel is detached. Install properly. Check interlock switch.
Is the CHECK light flashing?	The cell may be wet after cleaning. Dry it thoroughly. If not, call the Customer Service.
When functions do not work	
There is too much dust on the Pre-filter, activated carbon filter?	Clean the filters or replace them.
There is too much dust on the electronic cell?	Wash it and dry completely before reinstalling it.
The air inlet or outlet blocked?	Get rid of foreign materials around the outlets.
Automatic function does not work properly	
There is too much dust on the sensor?	Clean the dust on the sensor.
There is no dust on the sensor.	Call the Customer Service.

For all other problems

Check the problems first and then unplug the power cord. Call the Customer Service to ask for after-sale service or make inquiries.

Chapter 9

WIRING DIAGRAM

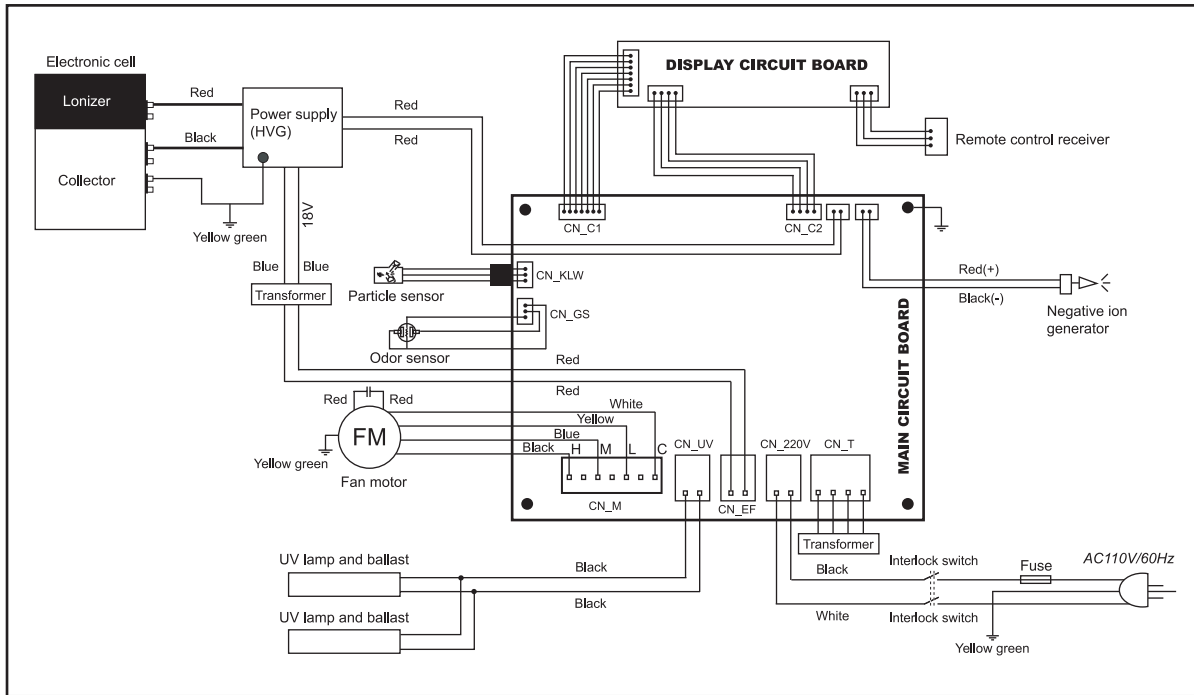

SERVICE REMINDER SCHEDULE

Pre-filter Wash Reminder

Year	<i>J</i>	<i>F</i>	<i>M</i>	<i>A</i>	<i>M</i>	<i>J</i>	<i>J</i>	<i>A</i>	<i>S</i>	<i>O</i>	<i>N</i>	<i>D</i>

Memo:

Electronic Cell Wash Reminder

Year	<i>J</i>	<i>F</i>	<i>M</i>	<i>A</i>	<i>M</i>	<i>J</i>	<i>J</i>	<i>A</i>	<i>S</i>	<i>O</i>	<i>N</i>	<i>D</i>

Memo:



SURGICALLY CLEAN AIR

3451 Lake Shore Blvd. W.
Toronto, ON M8W 1N2
Tel: 877.440.7770
www.surgicallycleanair.com
info@surgicallycleanair.com

*SCA reserves the right to revise or modify products and/or specifications without notice.
The contents of this manual are subject to change without notice.*

Ver. 6000C-01